

NOTES

- Contractors must check all dimensions on site. Only figured dimensions are to be worked from. Discrepancies must be reported to the Architect or Engineer before proceeding. © This drawing is copyright.
- Reproduced from OS Sitemap © by permission of Ordnance Survey on behalf of The Controller of Her Majesty's Stationery Office. © Crown copyright 2008. All rights reserved. Licence number 100007126.

KEY

- Boundary line
- - - A327 road level

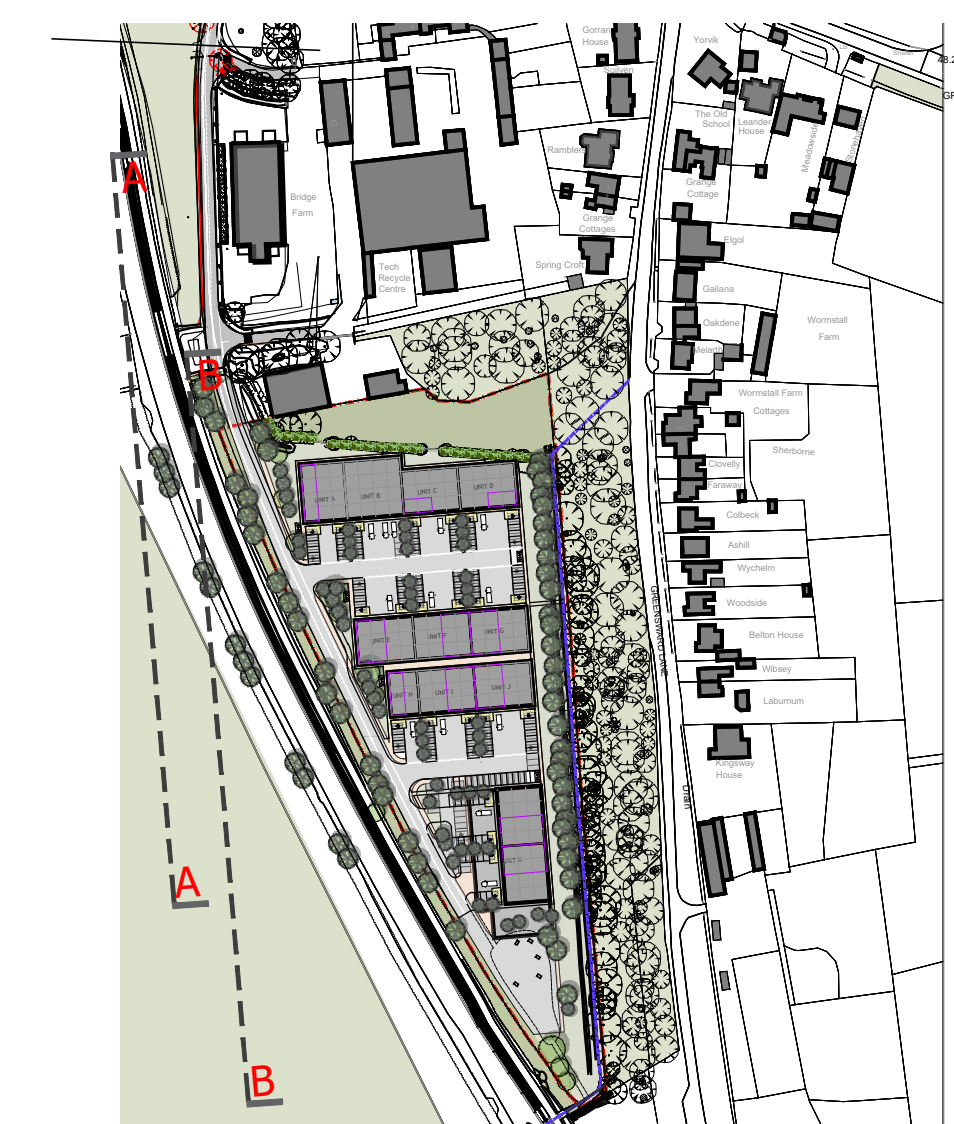
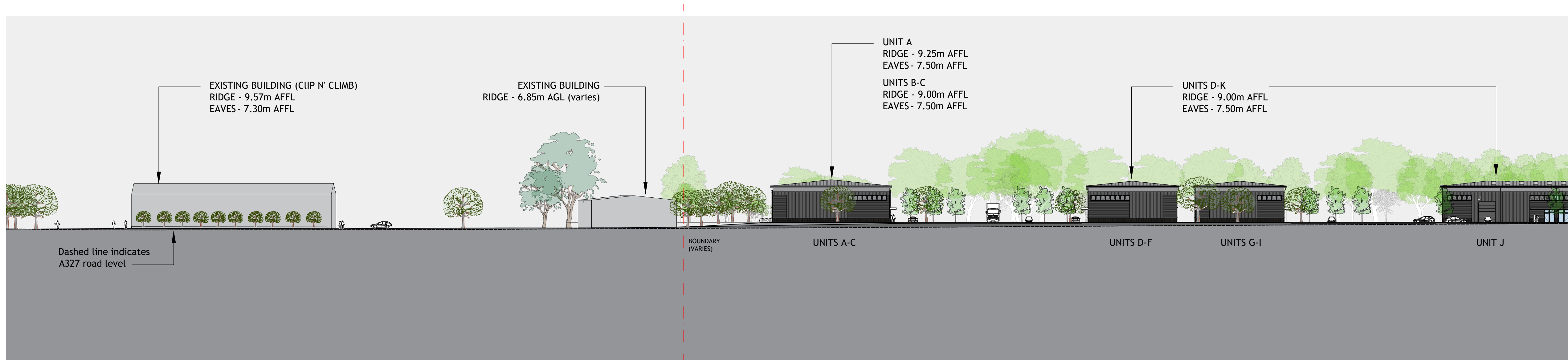

KEY PLAN

L	Updated to reflect SK18T. Section extend to include Clip N' Climb.	SA	SA	04/08/2023
K	Materials updated to reflect SK20	SA	SA	22/05/2023
J	Key Plan Updated	SA	SA	19/05/2023
H	Updated elevation	MA	SA	20/03/2023
G	Key Plan Updated	MA	SA	12/01/2023
F	Drawing retitled	SA	SA	10/08/2022
E	Drawing status updated	SA	SA	08/08/2022
D	Minor planting update & key plan updated	MA	SA	27/07/2022
C	Minor planting update	SA	SA	13/07/2022
B	Drawing renamed. Existing building height updated.	CWO	SA	04/07/2022
A	UPDATED FROM COMMENTS RECIEVED	BVT	SA	23/06/22

REV	DESCRIPTION	DRN	CHD	DATE

- PRELIMINARY
- INFORMATION
- TENDER
- CONSTRUCTION
- AS BUILT

SCALE 1:500 @ A1 DATE JUNE 2022

DRAWN BVT CHK SA

DRAWING NO. 18959-SK19 REV L

TITLE LAND SOUTH OF BRIDGE FARM ESTATE
READING ROAD, ARBORFIELD

DETAILS ILLUSTRATIVE STREET ELEVATION
MASSING

MASSING ELEVATION
PROPOSED A-A
SCALE 1:500
CT



MASSING ELEVATION
PROPOSED B-B
SCALE 1:500

PLANNING ISSUE

Woods Hardwick
Architecture | Engineering | Planning | Surveying

BEDFORD : HEAD OFFICE
15-17 Goldington Road
Bedford MK40 3NH
T: +44 (0) 1234 268862

BIRMINGHAM
Fort Dunlop, Fort Parkway
Birmingham B24 9FE
T: +44 (0) 121 6297784

ONLINE: mail@woodshardwick.com | woodshardwick.com

PLEASE CONSIDER THE ENVIRONMENT BEFORE PRINTING THIS DRAWING



This page is intentionally left blank